

PORTABLE AIR CONDITIONERS MONOBLOC UNIT

MUNDOCLIMA®

MUPO-C10 / H10 Series

with outlet pipe to the outside
and remote control



Ventilation function
It allows operation only with ventilation.



Remote control
Includes wireless remote control.



Air discharge tube to the outside
Easy and quick to install, it allows the use of the air conditioner immediately.



Dehumidification
Moisture reduction restoring an optimum temperature in wet areas.



Condensate removal
Removes condensate water so it is not necessary to connect the air conditioner to a drain. In dehumidification mode and in very humid environments, it is recommended to connect the equipment to a drain.

NEW!



MUPO-07-C10



MUPO-09-H10



Price List

7000 BTU €350

9000 BTU €430

Window kit included

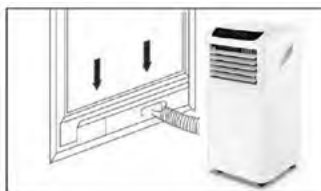

TECHNICAL SPECIFICATIONS

MODEL		MUPO-07-C10	MUPO-09-H10
Code		CL 20 020	CL 20 021
Cooling	Nominal capacity	kW	2.05
	Nominal consumption PEER	kW	0.78
	EERd	W/W	2.63
	Energy labeling		A
	Electricity Consumption QSD	kWh/60min.	0.778
Heating	Nominal capacity	kW	--
	Nominal consumption PCOP	kW	--
	COPd	W/W	--
	Energy labeling		A
	Electricity Consumption QSD	kWh/60min.	--
Power consumption in thermostat-off mode PTO		W	--
Standby power consumption PSB		W	0.5
LWA sound power level		dB(A)	65
Power supply		V-Hz-Ph	220-240V~ 50Hz, 1N
Max. intensity		A	3.5
Air flow rate	Indoor (High / Low)	m ³ /h	300 / 280
	Exterior	m ³ /h	300
Refrigerant	Type / PCA	R290 / 3	
	Number	kg / TCQeq	0.12 / 0.0
Dimensions (W x D x H)		mm	300 x 300 x 700
Weight		kg	20

Warning:1. Data and specifications are subject to changes without previous notice.

2. The values of sound power level match with values obtained in the anechoic chamber.